

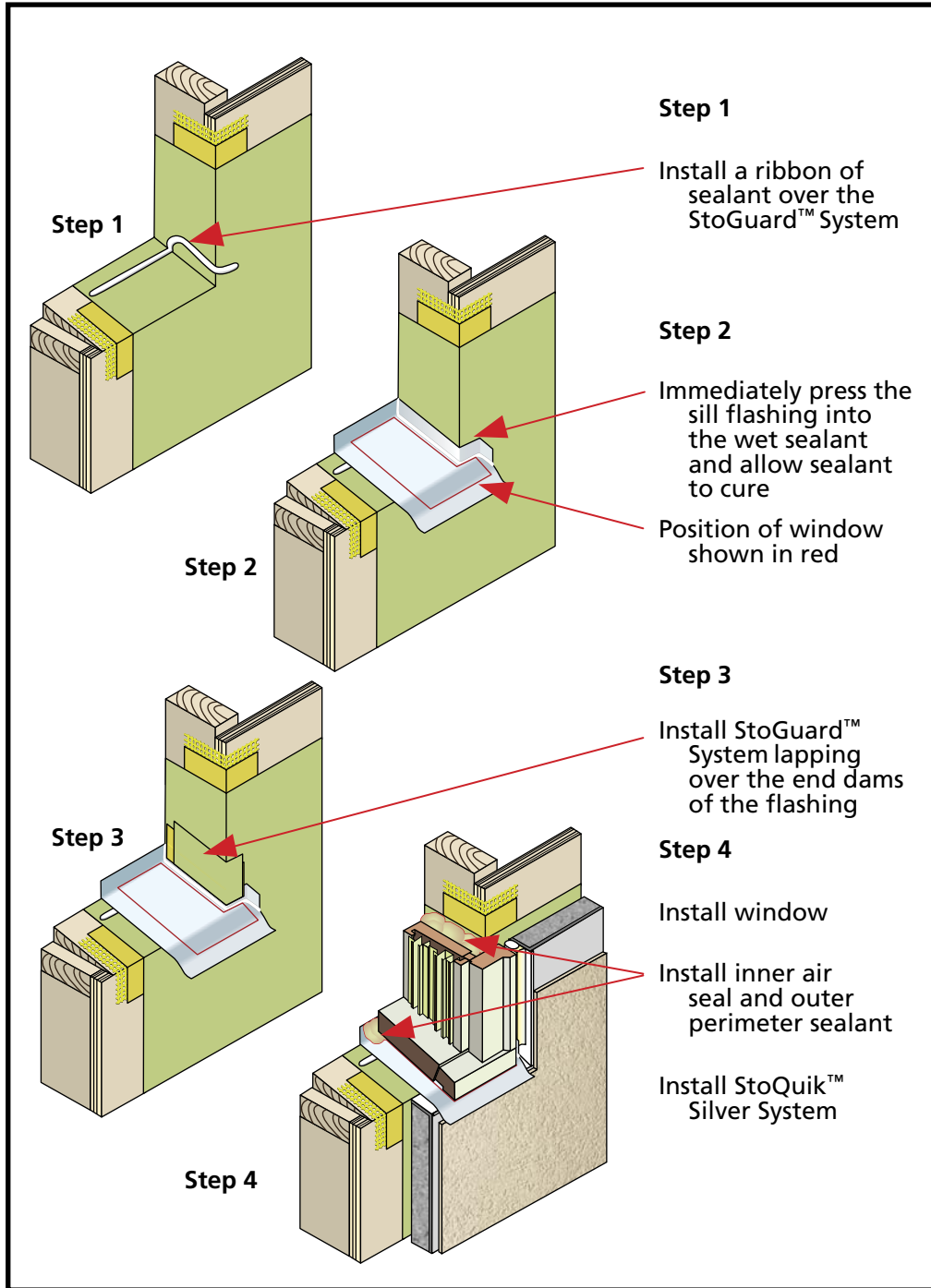

StoQuik™ Silver NEXt Sill Pan Flashing: Brick Mold Window over Wood Frame

Detail No.: 11.26a

Date: November 2007



Notes:

Step 1

1. Install sealant to provide an air seal between the StoGuard System and pan flashing.

Step 2

2. Press the pan flashing into place and, if necessary, fasten through the wet sealant.

Step 3

3. Install a patch of StoGuard Mesh, Sto Gold Fill and Sto EmeraldCoat over the end dam of the flashing so water draining down the jamb will be directed into pan flashing.

Step 4

4. Install the window and seal the interior perimeter with an air seal. Install the StoQuik Silver System and provide a seal between the head and jambs of the window. Allow water to drain the sill.
5. Building codes vary with respect to the type of water-resistive barrier and the number of layers required over wood-based sheathing. Check the applicable code requirement to ensure compliance.
6. Refer to Sto Specification QS 200E for complete information on design requirements, installation and accessories.

ATTENTION

Sto products are intended for use by qualified professional contractors, not consumers, as a component of a larger construction assembly as specified by a qualified design professional, general contractor or builder. They should be installed in accordance with those specifications and Sto's instructions. Sto Corp. disclaims all, and assumes no, liability for on-site inspections, for its products applied improperly, or by unqualified persons or entities, or as part of an improperly designed or constructed building, for the nonperformance of adjacent building components or assemblies, or for other construction activities beyond Sto's control. Improper use of Sto products or use as part of an improperly designed or constructed larger assembly or building may result in serious damage to Sto products, and to the structure of the building or its components. **STO CORP. DISCLAIMS ALL WARRANTIES EXPRESSED OR IMPLIED EXCEPT FOR EXPLICIT LIMITED WRITTEN WARRANTIES ISSUED TO AND ACCEPTED BY BUILDING OWNERS IN ACCORDANCE WITH STO'S WARRANTY PROGRAMS WHICH ARE SUBJECT TO CHANGE FROM TIME TO TIME.** For the fullest, most current information on proper application, clean-up, mixing and other specifications and warranties, cautions and disclaimers, please refer to the Sto Corp. website, www.stocorp.com.

www.stocorp.com